

Snap Connector And End Cap Assembly

SNAP Connector

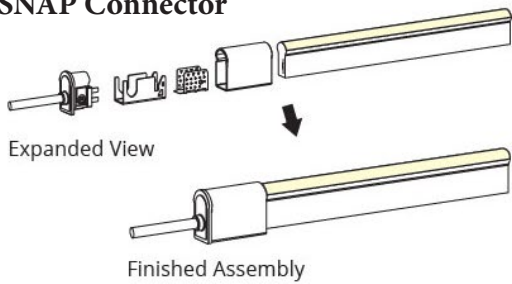

SNAP End Cap

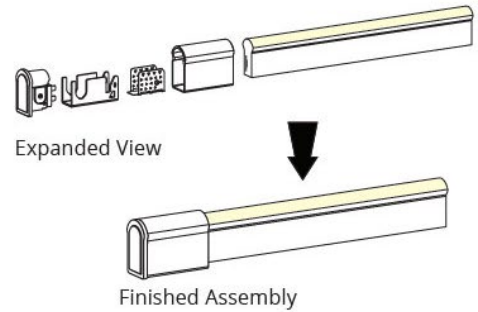

Before Beginning:

Always select the correct connector for the end of the light. Connectors are marked with an 01 and 02 and correspond with the printed numbers on the fixture.

01 | Components of Snap Connector/End Cap

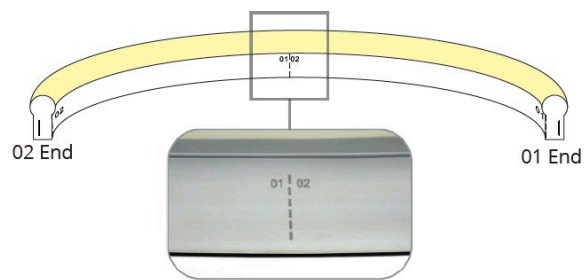

Grip Plate (1pc)

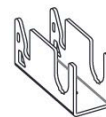

Compression Clip (1pc)

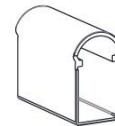

Snap Cover (1pc)

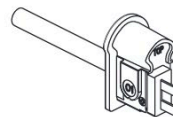

Lead Connector (1pc)
[Contains Silicone Gasket (1pc)]



End Fitting (1pc)
[Contains Silicone Gasket (1pc)]

02 | Tools

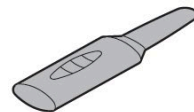

Expanding Tool

Snap Connector And End Cap Assembly

03 | Installation Steps

03.1 | Placing Snap Cover

When placing snap cover, be sure to pay attention to the direction marked on the bottom.

The snap end of the cover points towards the assembly end.

Fig. 1: directions printed on the under side of the snap cover.

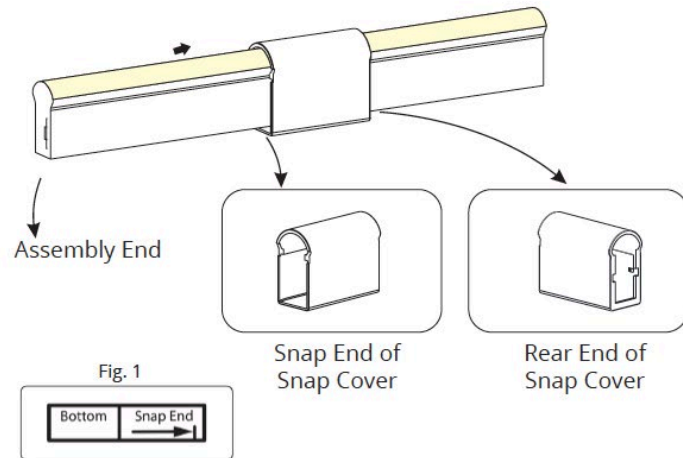

03.2 | Creating a gap for Lead Connector/End Fitting

Insert the expanding tool behind the PCB. Move the tool up and down 3 to 5 times gently to create a small gap.

NEVER insert the expanding tool into the front side (LED side) of the PCB.

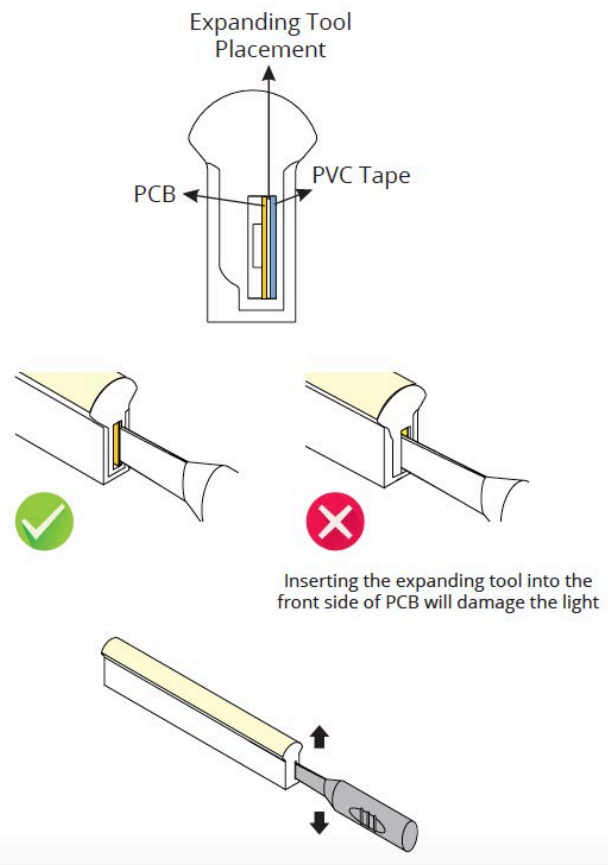

Snap Connector And End Cap Assembly

03.3 | Inserting the Lead Connector/End Fitting

Carefully insert the pins of the lead connector/end fitting into the gap you created behind the PCB (Fig. 1). There should be a space of 0.125in to 0.25in (2-5mm) between the lead connector/end fitting and the light fixture when properly installed.

DO NOT insert the pins into the front side of the PCB. (Fig.2)

DO NOT split the pins around the PCB (Fig.3).

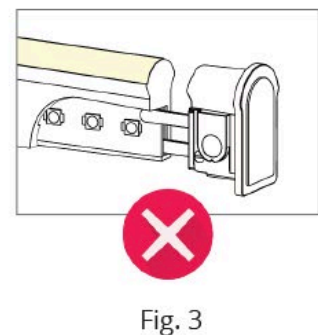
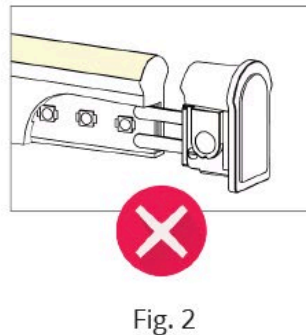
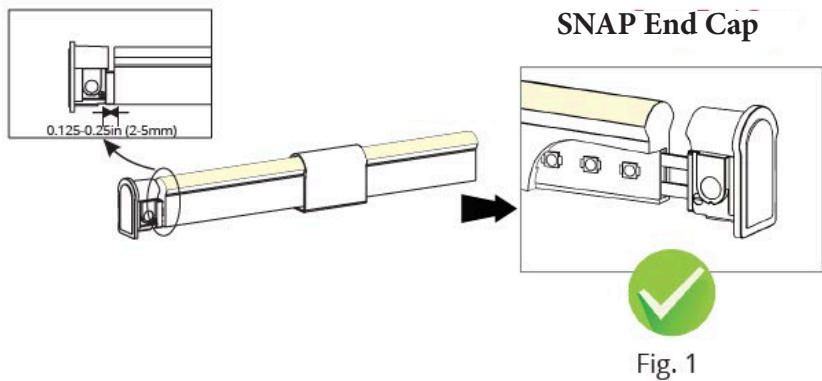
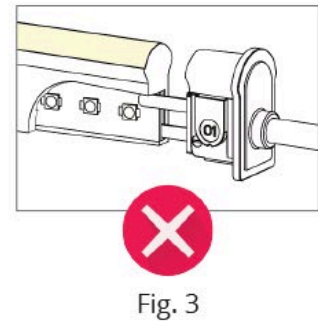
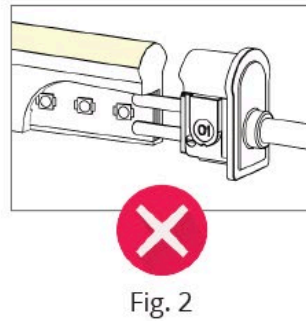
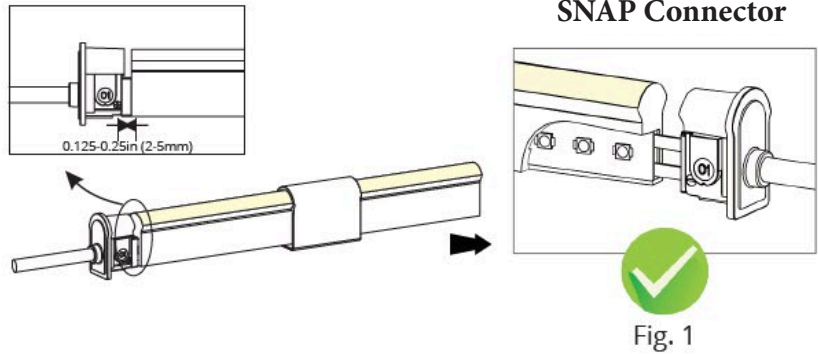

Snap Connector And End Cap Assembly

03.4 | Preparing the Grip Plate

Unfold the grip plate about 20 degrees on both sides.

03.5 | Installing the Grip Plate

Place the grip plate onto the assembly end of the light. Make sure it is facing the correct way with the extending metal tab sticking out from the assembly end and the side edges flush with the cut edge of the fixture.

Make sure the plate is snug to the fixture.

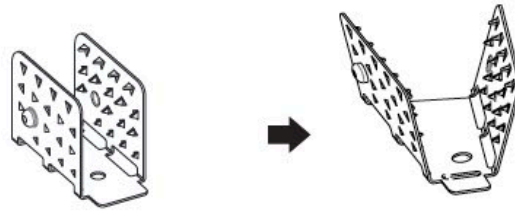

SNAP Connector

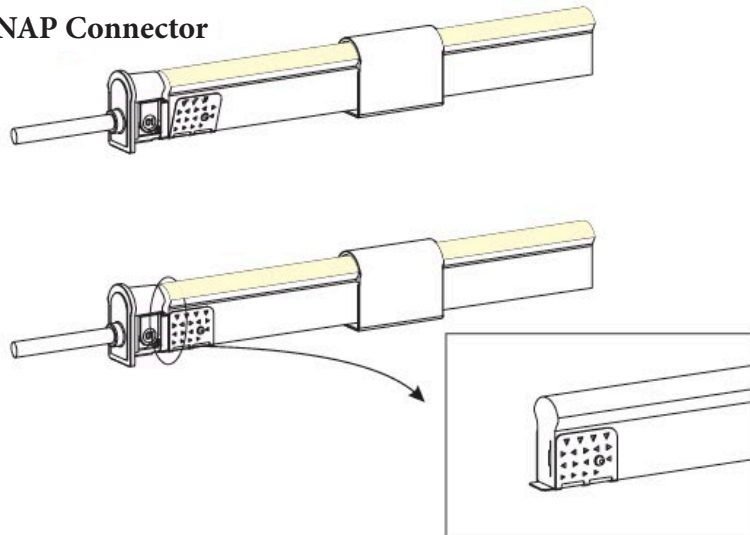

SNAP End Cap

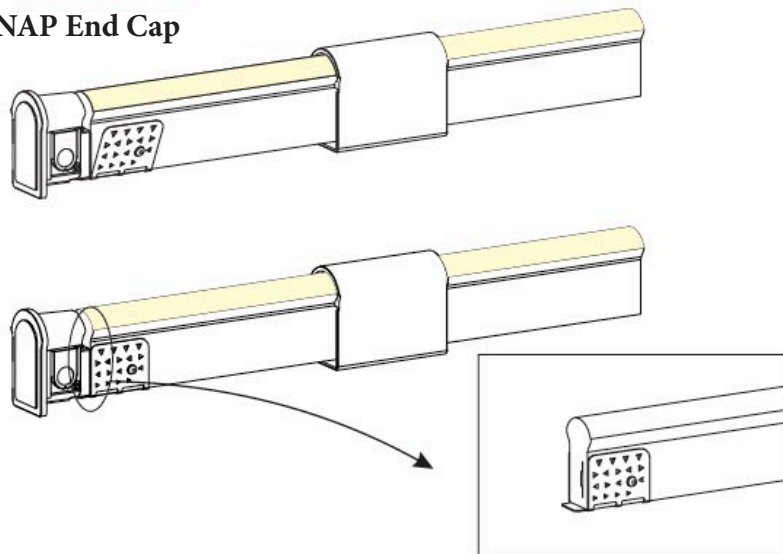

Snap Connector And End Cap Assembly

03.6 | Compression clip and Snap Cover Installation

Align the lead connector and grip plate with the compression clip (Fig. 4).

Apply even pressure to the lead connector and light fixture, pressing them into the compression clips until they are sitting flush along the bottom of the clip with no gaps. This will pull the fixture tight to the lead connector (Fig. 5).

Slide the snap Cover back towards the lead connector until you hear it snap into place.

Power your fixture to ensure that it is working properly.

SNAP Connector

Fig. 4

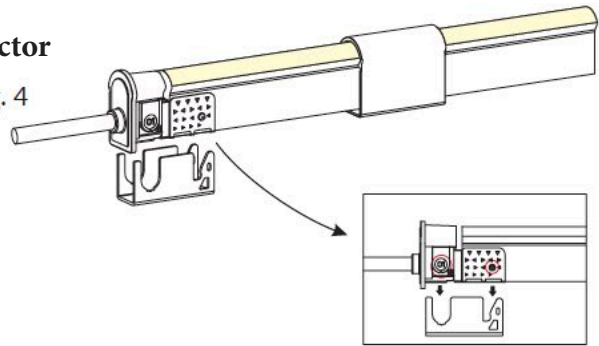
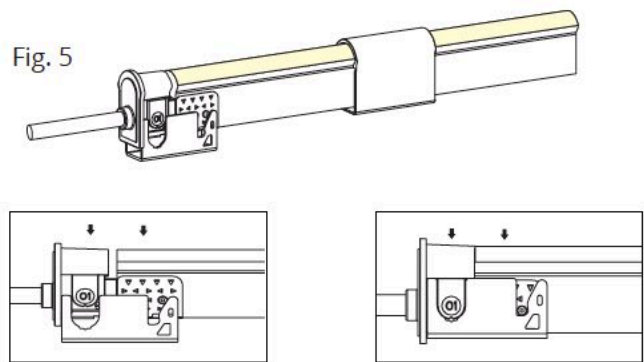

Fig. 5



SNAP End Cap

Fig. 4

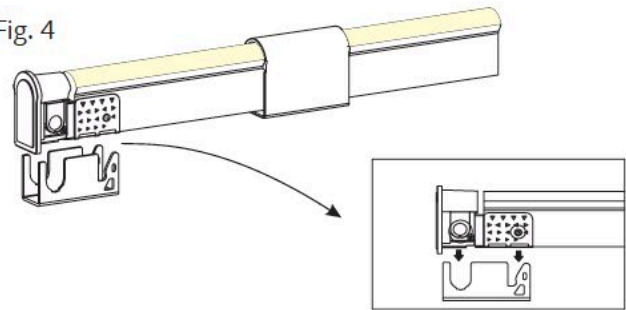
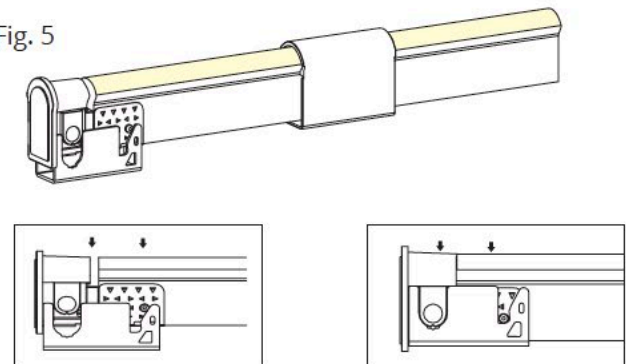

Fig. 5



Snap Connector And End Cap Assembly

03.6 | Compression clip and Snap Cover Installation

Slide the snap Cover back towards the lead connector until you hear it snap into place (Fig. 6).

Power your fixture to ensure that it is working properly.

SNAP Connector

Fig. 6

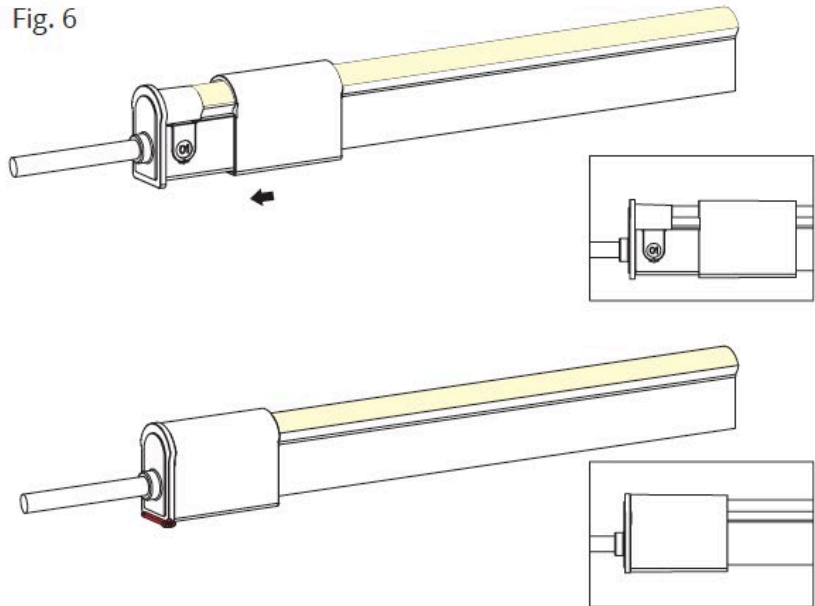

SNAP End Cap

Fig. 6

